



Feature :

Multiple keys and poles
Interlock and individual lock

Application :

Various switching purpose
Home electronic equipments
Industrial equipments

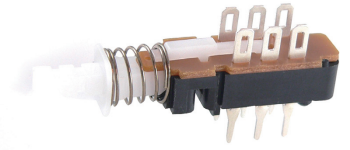

SWITCH SPECIFICATIONS	
POLE - POSITION	2P2T, 4P2T, 6P2T, 8P2T, 10P2T, 16P2T, Momentary and Lock Type Available
CONTACT RATING	25 V DC , 1 A ; 125 V AC , 0.2 A
CONTACT RESISTANCE	40 mΩ MAX. 1.5 V DC ; 100 mA , by Method of Voltage DROP
INSULATION RESISTANCE	100 MΩ MIN. 500 V DC
DIELECTRIC STRENGTH	Breakdown is not Allowable ; 500 V AC for 1 Minute
OPERATING FORCE	2P2T , 4P2T , 6P2T : 350 ± 150gf ; 8P2T , 10P2T , 16P2T : 600 ± 150gf
OPERATING LIFE	10,000 cycles
OPERATING TEMPERATURE RANGE	-40°C ~ 85°C
OPERATING TRAVEL	2.0 ± 0.3 mm

▶ HOW TO ORDER

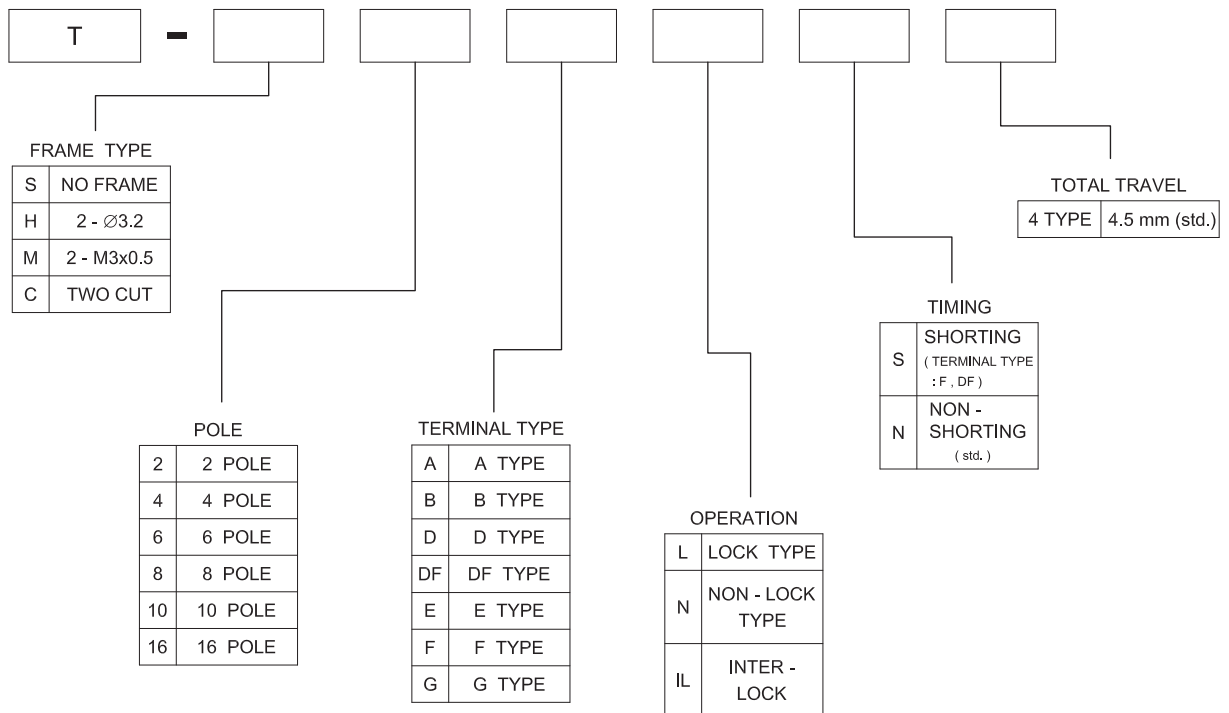



► DIMENSION

T - S2ANN4

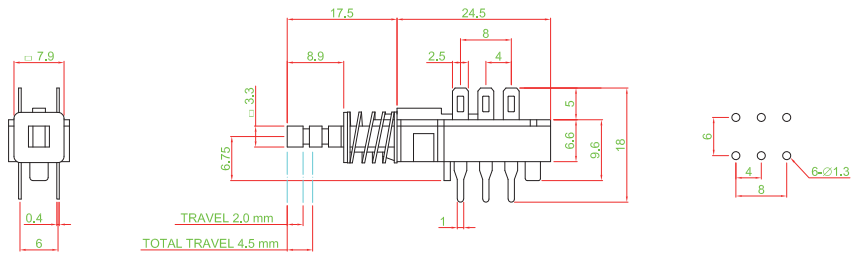
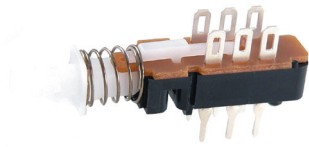

T - H2ALN4

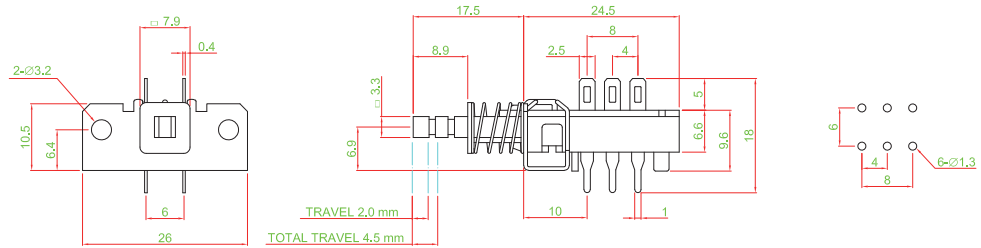
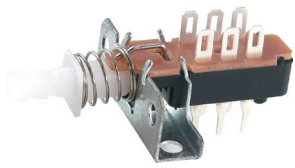

T - M2ANN4

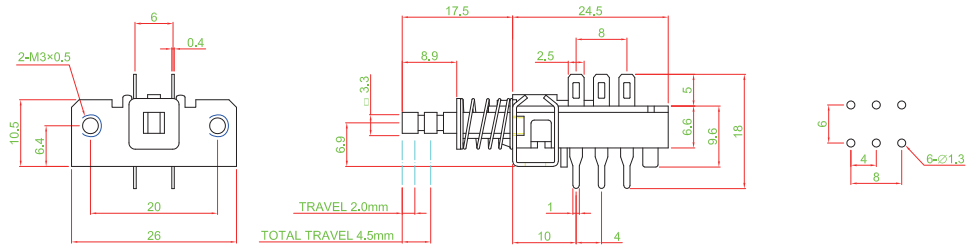
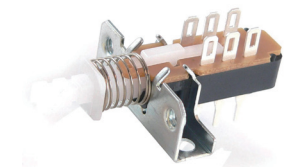

T-S4G/2ALN4

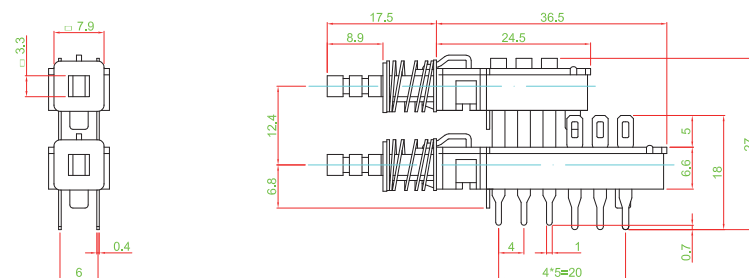
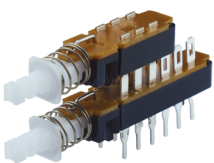

► FRAME TYPE

S TYPE

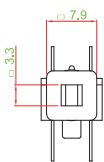

H TYPE

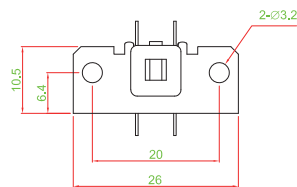

M TYPE

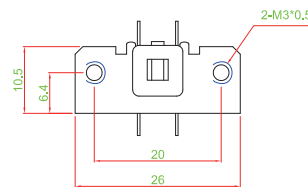

C TYPE

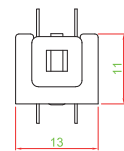

► TERMINAL TYPE

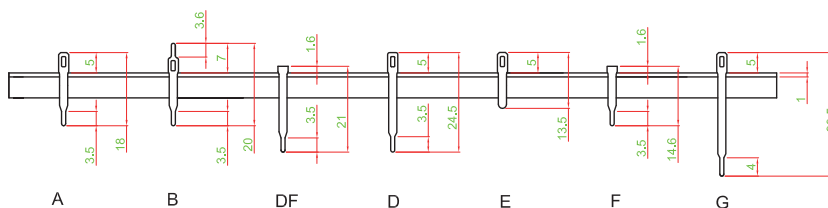

TACT SWITCH

PUSH BUTTON SWITCH

LED TOUCH SENSOR SWITCH

5 DIRECTION NAVIGATION SWITCH WITH LED

MEMBRANE SWITCH

LED LIGHT BAR

SLIDE SWITCH

ROTARY SWITCH

ROCKER SWITCH

DETECT SWITCH

ENCODER

INTERRUPTER

MINIATURE MICRO SWITCH

TELEPHONE HOOK SWITCH

DOOR SWITCH

MINI SIZE SOCKET

KNOB

CAP SYMBOL



► CIRCUIT

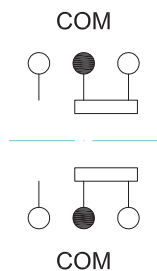

► POLE & LENGTH

POLE	2	4	6	8	10	16
L(mm)	24.5	36.5	48.5	60.5	72.5	108.5

► INTER-LOCK & LENGTH

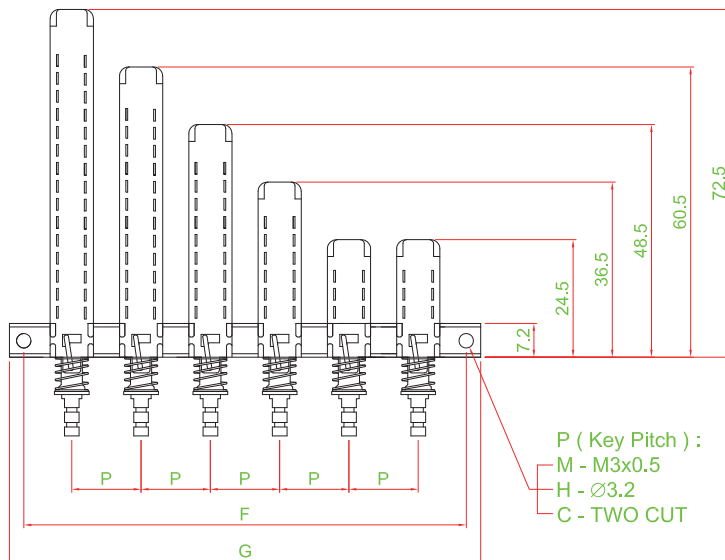
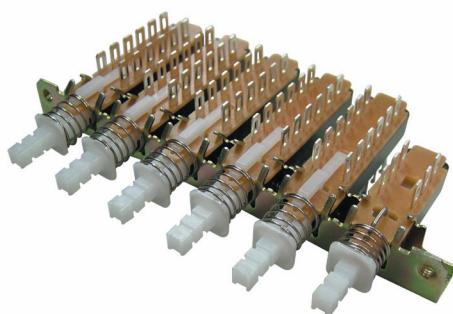

SIZE PITCH	G		F			G		F			G		F			G		F	
	G	F	G	F		G	F	G	F		G	F	G	F					
10	26	20	46	40		66	60	86	80		106	100							
12.5	24	18	51	45	3	76	70	101	95	9	126	120							
15	/		56	50		86	80	116	110		146	140							
17.5			61	55	F	96	90	F	131	125	F	166	160						
20			66	60		106	100	146	140		186	180							
10	36	30	56	50		76	70	96	90		116	110							
12.5	38.5	32.5	63.5	57.5	4	88.5	82.5	113.5	107.5	10	138.5	132.5							
15	41	35	71	65		101	95	131	125		161	155							
17.5	43.5	37.5	78.5	72.5	F	113.5	107.5	F	148.5	F	183.5	177.5							
20	46	40	86	80		126	120	166	160		206	200							

► MULTI - KEY TYPE AND INTER - LOCK TYPE

FRAME TYPE M M3x0.5 H Ø3.2 C TWO CUT

KEY	1	2	3	4	5	6	7	8	9	10	11	12	13	14	15	16
OPTION / 選項																
POLE / 回路數																
TERMINAL TYPE / 端子																
OPERATING / 動作																
TIMING N / S																
TRAVEL / 行程																
KNOB																
PITCH / 間距	<input type="checkbox"/> 10mm <input type="checkbox"/> 12.5mm <input type="checkbox"/> 15mm <input type="checkbox"/> 17.5mm <input type="checkbox"/> 20mm <input type="checkbox"/> 25mm <input type="checkbox"/> 30mm															